



## DE HARO STREET



## Community Project

# De Haro Street Community Project

# Project outline | November 2021



# Our Mission

- To join together as a community to improve, enhance, and beautify the 1300 block of De Haro Street.
- To create a connected and unified neighborhood greenbelt for all residents of the Southern Slope of Potrero Hill.
- As the neighborhood becomes denser and more populated, our vision is to provide a safer and more sustainable environment for the community.

We are proud to partner with



We are proud to have the support of:



# Historic View

De Haro Street between  
24th and 25th Street in 1941



# Current View

De Haro Street between  
24th and 25th Street in 2021

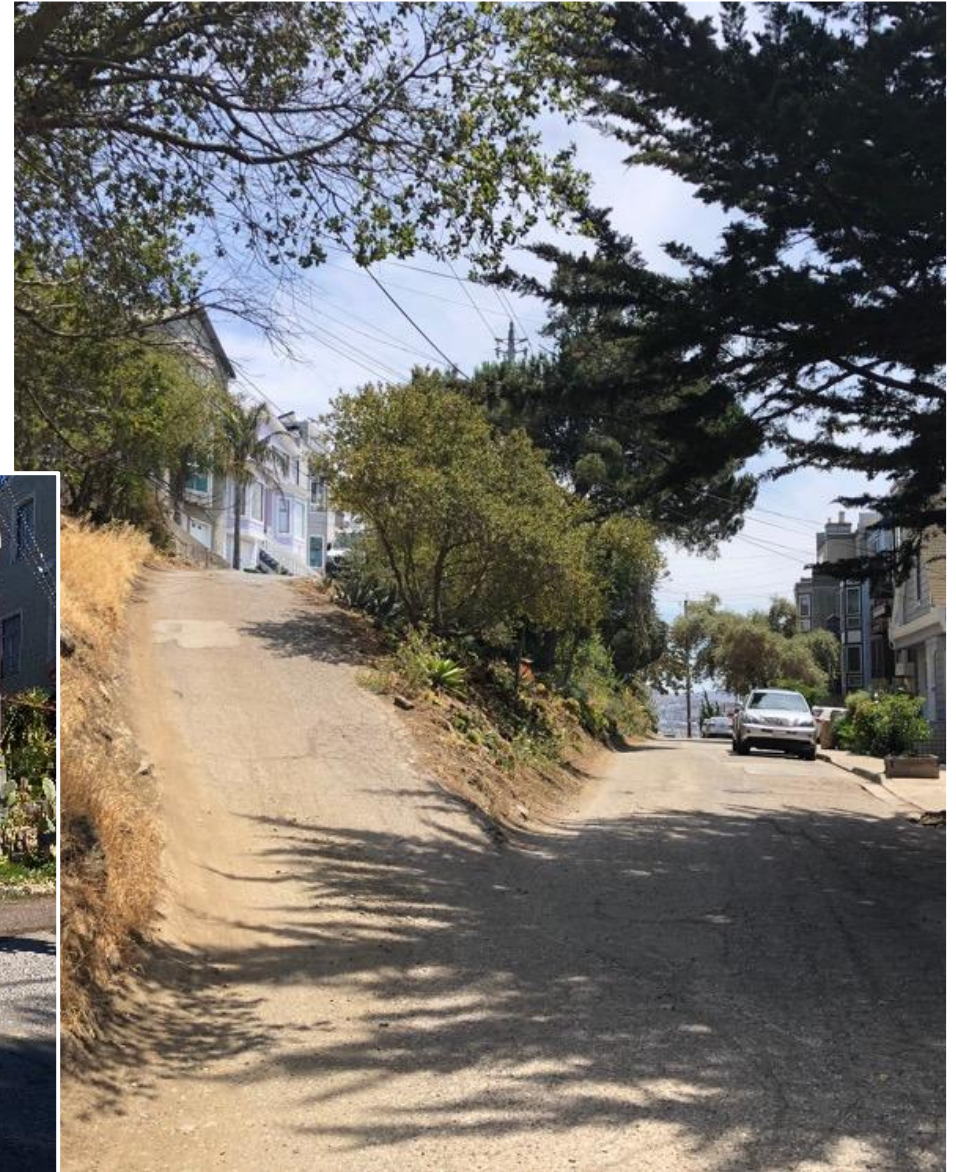

# Our Median

The De Haro Street median is a hidden gem of San Francisco – one of a dwindling few wild medians left in our beautiful City. With bursting apple-green outcroppings of California's state rock, serpentine, gracing the median, this greenspace has been planted and protected by neighbors for decades.

Now, recognized by the city of San Francisco as a “Street Park”, our community group is eager to conserve and safeguard this hidden gem so it can be shared for all to enjoy as part of a greater walkable greenbelt on the south side of Potrero Hill.

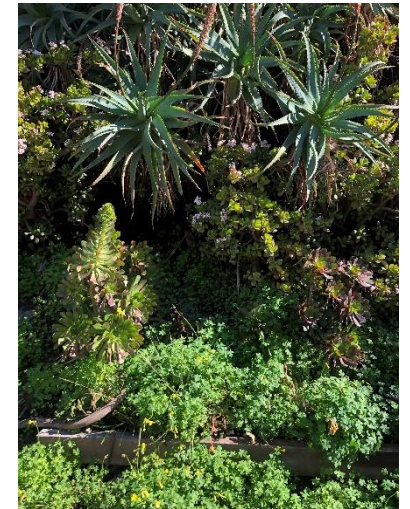

# Working Together, Strengthening Community





# The Problems



# Problems Addressed by the Project

- **Neglected “Street Park”:** Although the median is on property owned by the Department of Public Works, there has been no maintenance or upkeep for many decades. It has become a depository for broken glass, needles, and debris. Neighbors have taken on the responsibility for clean-up and planting over the years. However, we can only do so much on our own and are now seeking help to keep it safe and beautiful for our greater community.
- **Serious safety concerns:**
  - **Erosion and drainage issues:** Run-off flows into the street, bringing soil from the slope across the road, has lead to significant hillside erosion and the burying of any proper drainage infrastructure. Lower De Haro becomes a narrower street every year as a result.
  - **Crumbling street:** Soil from under the Upper De Haro road is being washed out below the asphalt because there is no soil retention, and large pieces of road are breaking off. The chunks slide down the slope, taking out plants and exposing soil which causes more erosion, and making for dangerous walking and driving. There is increased traffic due to increasing population density in the neighborhood and because the lower street was recently turned into a one-way street, traffic is forced to drive upon the crumbling upper street, which is making things worse daily.

# Lower De Haro:



## Erosion and Narrowing of Roadway

Lack of any retaining wall on the lower slope of the median creates erosion, mud slides, and excessive dirt and dust. The street is continuously getting narrower as a result of the erosion which leaves inadequate space for transit. This narrowing creates an unsafe environment for cars and pedestrians in our community. Run off flows into street bringing soils from slopes into the street and leading to significant hillside erosion and mudslides in the winter, and high dust particulates in the summer, stirred up by cars driving over the soil.

# Upper De Haro:



**Eroding road on  
Upper De Haro Street**



**Constant flow of garbage down crumbling hillside, creating  
broken glass and hazardous waste issues.**



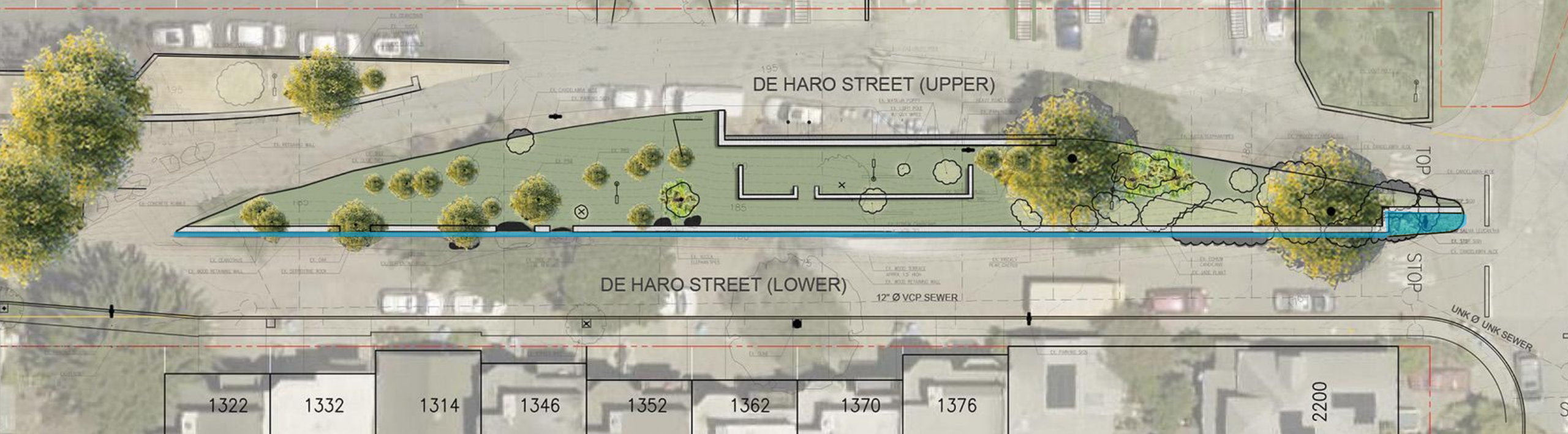

# Our Solution – A Holistic Vision

# Holistic Vision – A Two Phase Project

We have worked with Terrain Studios to develop a holistic, two phase solution to problems we are facing on De Haro Street which keep our “street park” from reaching its true potential.

Each phase addresses key improvement requirements, in service of creating a seamless interconnected greenbelt that serves the larger neighborhood, fostering a more beautiful and safer pedestrian-friendly community, while also being an environmental green infrastructure solution we can be proud of.



A Connected Neighborhood Pedestrian Walk-able Greenbelt

# Holistic Vision – A Two Phase Project

## Phases Overview

### **Phase 1 – Lower De Haro Rainwater Management and Beautification**

Addresses erosion and drainage issues, while significantly enhancing the beauty and sustainability of the hillside by installing a gabion retaining wall along the lower street. Elements include installing permeable soil retention, permeable drainage with overflow leading to a raingarden, low flow irrigation, and drought tolerant, pollinator-friendly landscaping.

*Our goal is to apply for a Watershed Stewardship Grant for this phase in 2021.*

### **Phase 2 – Upper De Haro Terracing & Raingarden Project**

Terraces the hill side and then landscapes those terraces with native, drought tolerant pollinator plants, additional permeable drainage with raingardens, and extends gabion retaining walls along the upper street.

*Our goal is to apply for a Community Challenge Grant/Watershed Stewardship Grant for this phase in 2022/23.*



# Conceptual Plan



# Existing Stormwater Flow Analysis

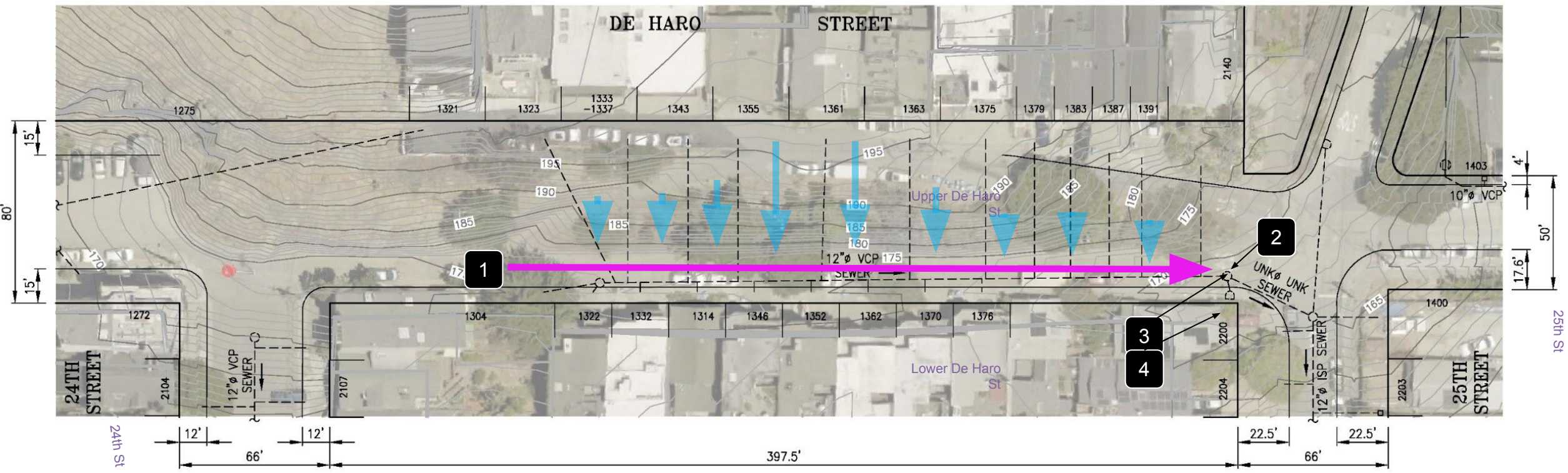

- 1 High Point of Lower De Haro (+/- 175.00)
- 2 Low Point of Lower De Haro (+/- 164.00)
- 3 Existing Sewer Manhole
- 4 Existing Curb Inlet

PLAN  
SCALE: 1"=30'

Legend

- Street Stormwater
- Surface Runoff
- Median Stormwater
- Surface Runoff

# Conceptual Master Plan

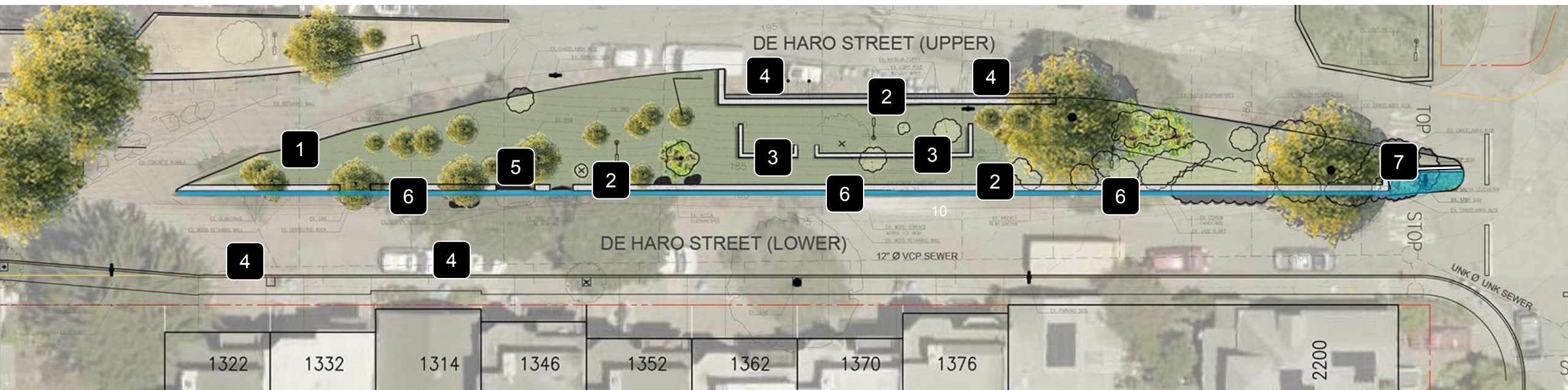



- |   |  |   |   |
|---|--|---|---|
| 1 | De Haro Community Signage                                    | 5 | Exposed serpentine rock outcroppings interrupting gabion walls          |
| 2 | 18" wide gabion basket wall filled with serpentine like rock | 6 | Stormwater collection pervious bioswale / gutter at base of gabion wall |
| 3 | 12" wide gabion basket wall filled with serpentine like rock | 7 | Infiltration Planter / Rain Garden                                      |
| 4 | Parallel parking   | 8 | Asphalt Street  |

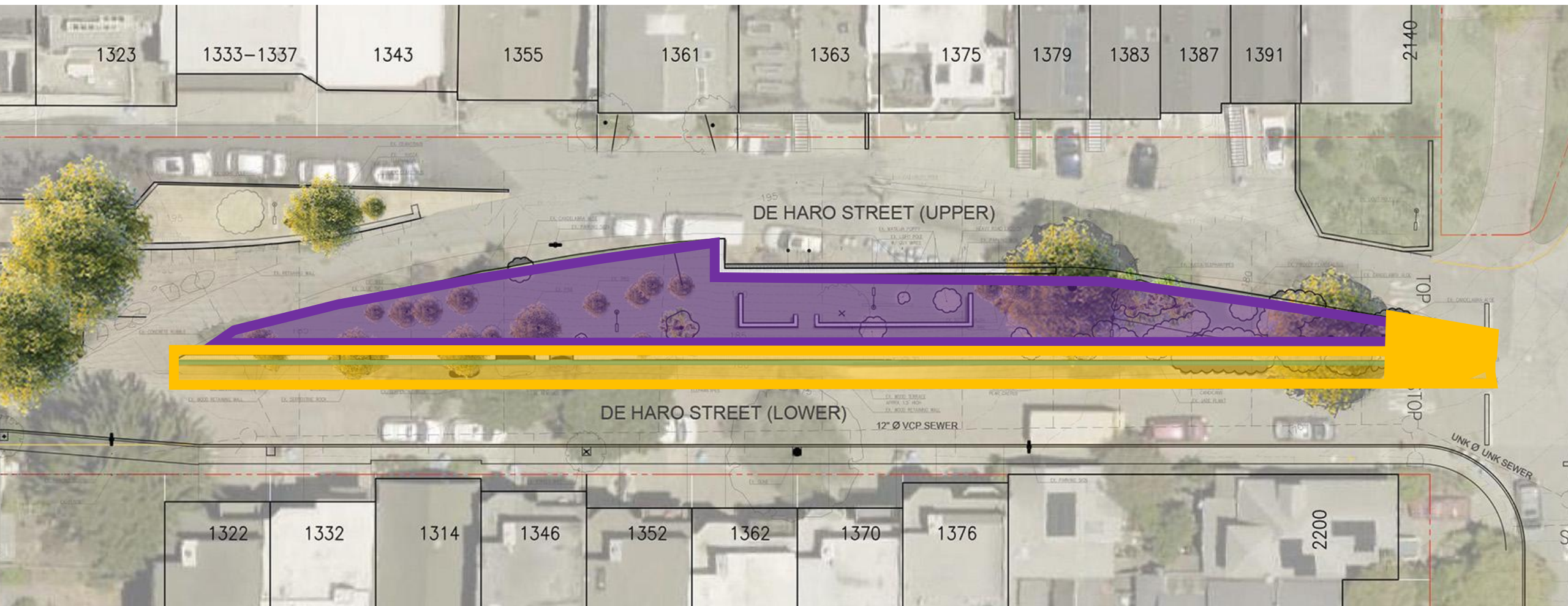

# Conceptual Plan – Phase 1 and Phase 2



-  Phase 1 – Lower De Haro Beautification Project
-  Phase 2 – De Haro Median Planting and Terracing Project

# Lower De Haro Rainwater Management and Beautification – Phase 1 Plan

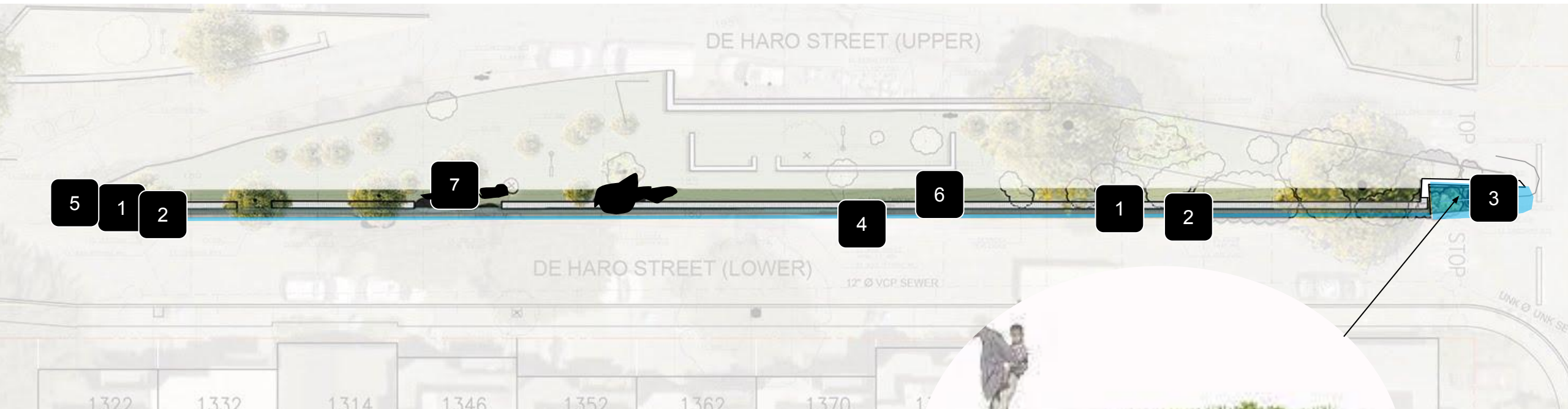

- 1** 18" wide gabion basket wall filled with serpentine like rock
- 2** Stormwater collection pervious bioswale / gutter at base of gabion wall
- 3** Infiltration planter / rain garden
- 4** Repair asphalt road where excavation and construction occurred
- 5** Community signage
- 6** Succulent and native planting
- 7** Exposed serpentine rock





## Current Conditions

- 1** Street is too narrow making it difficult for drives, delivery trucks and bicyclists to safely navigate the street. Additionally, the street is too narrow to be acceptable for the Department of Public Works
- 2** Planting is overgrown, unattractive and creates visual barriers into the hill side
- 3** Run off flows into street bringing pollutants and sediments from Upper De Haro and median slumping slopes into the street and the storm sewer system

Current Conditions – Lower De Haro

# Conceptual Rendering - Phase 1

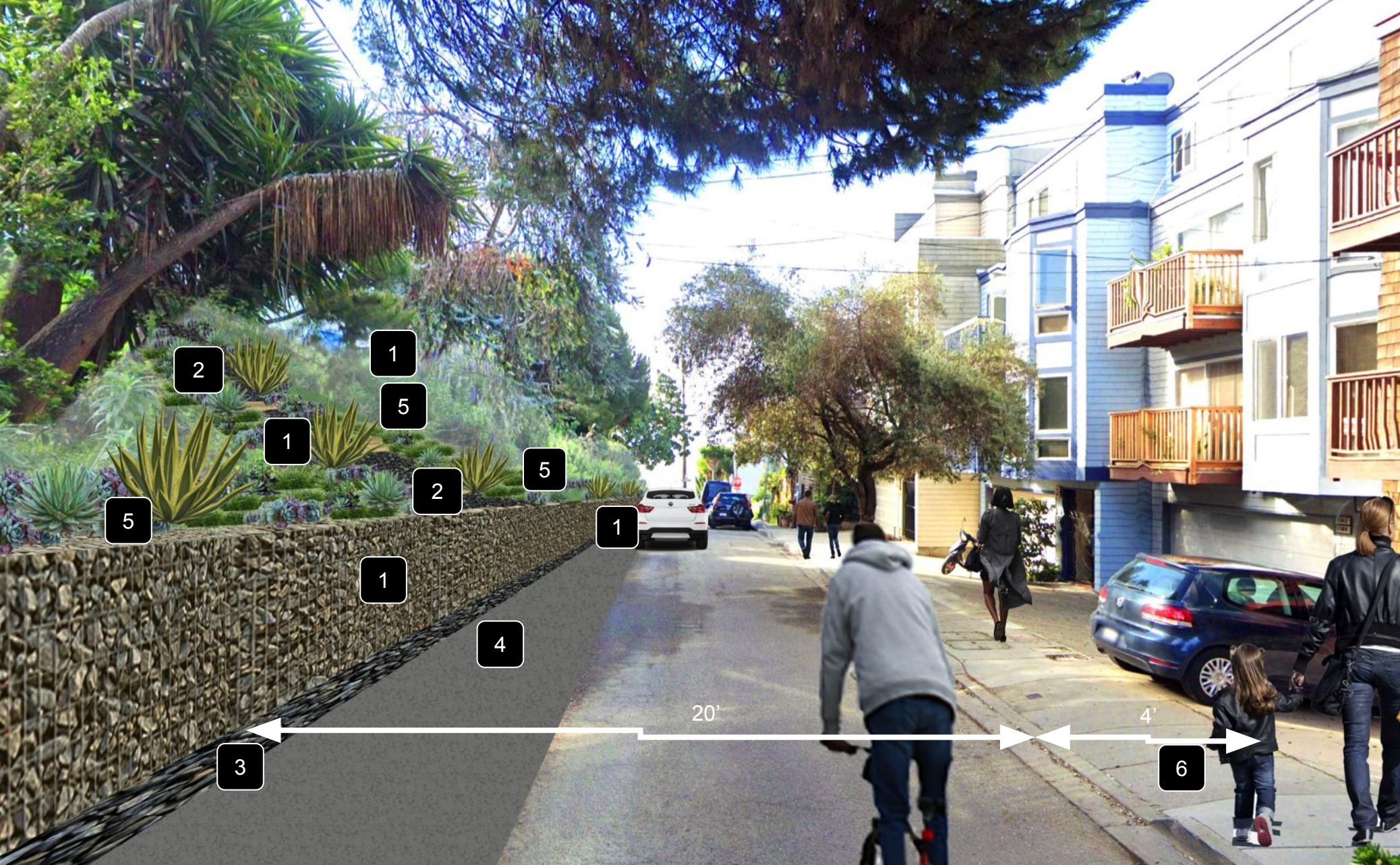

- 1 Gabion Retaining Wall Captures on Retains Pollutant and Sediment Runoff
- 2 Stormwater Runoff Collection Via Pervious Gravel Bioswale / Gutter at Base of Gabion Wall Filters Minor Runoff Coming Through the Gabion Wall and Conveys it to the Infiltration / Rain Garden at 25<sup>th</sup> Street
- 3 New stone faced steps
- 4 Repaired Asphalt
- 5 New native / naturalized planting
- 6 Existing Curb and Sidewalk to remain

Conceptual Rendering – Phase 1

## Conceptual Plan – Phase 2 – Rendering Upper De Haro

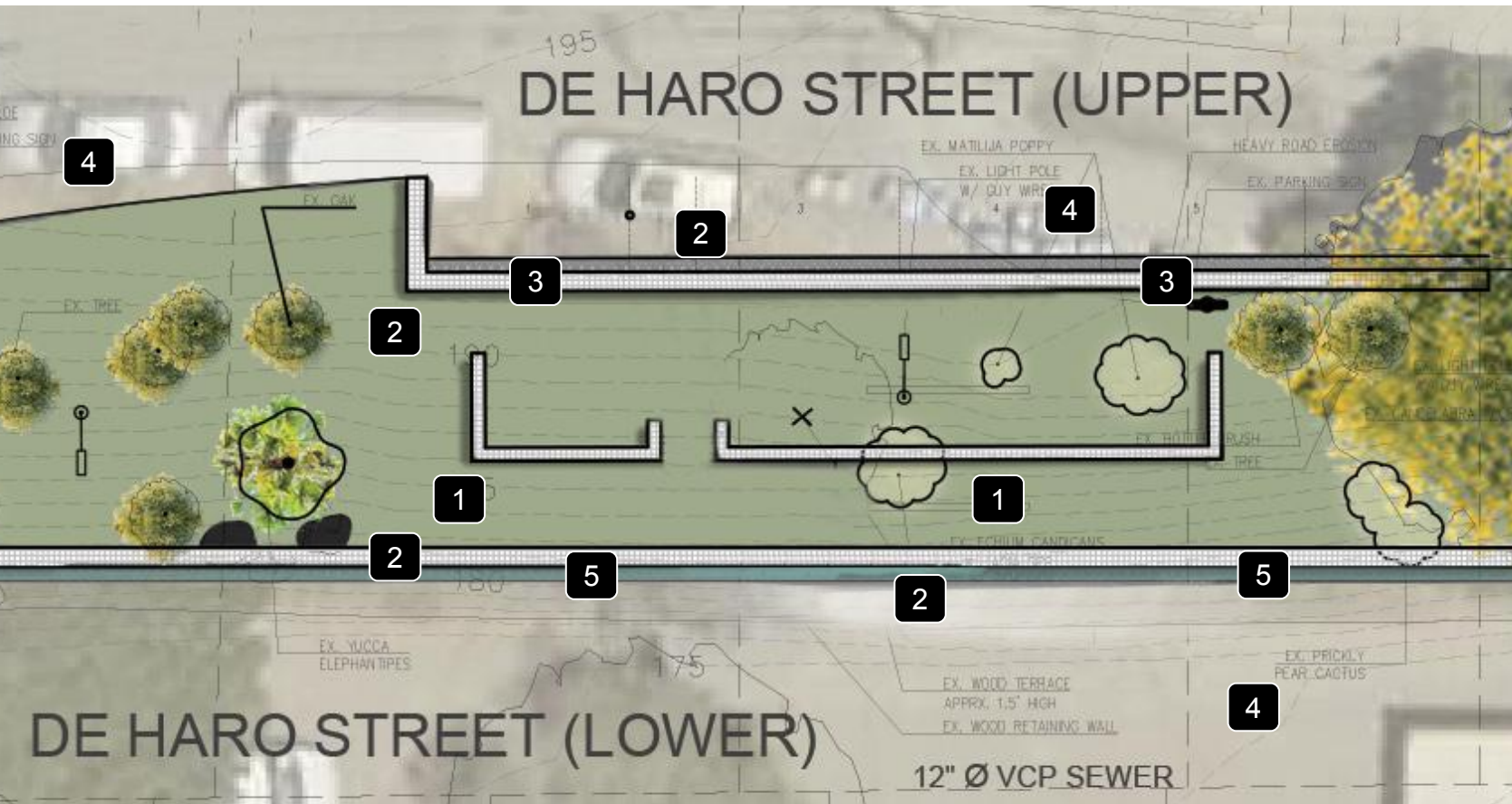

Phase 2 would install a retaining wall to keep the upper street from further eroding down the slope.

Together with the proposed terraces, the hillside would stop sliding and we will be able to plant to beautify the slope for all.

Additionally, the soil stabilization would improve the safety on the upper road.

The upper retaining wall would also prevent the flow of garbage, broken glass, and hazardous waste from raining down the slope weekly.

- 1 12" wide gabion basket wall filled with serpentine like rock
- 2 18" wide gabion basket wall filled with serpentine like rock
- 3 Gravel drainage edge, 12" wide

- 4 Asphalt Street
- 5 Stormwater collection pervious bioswale / gutter at base of gabion wall

# Wall Height Diagram

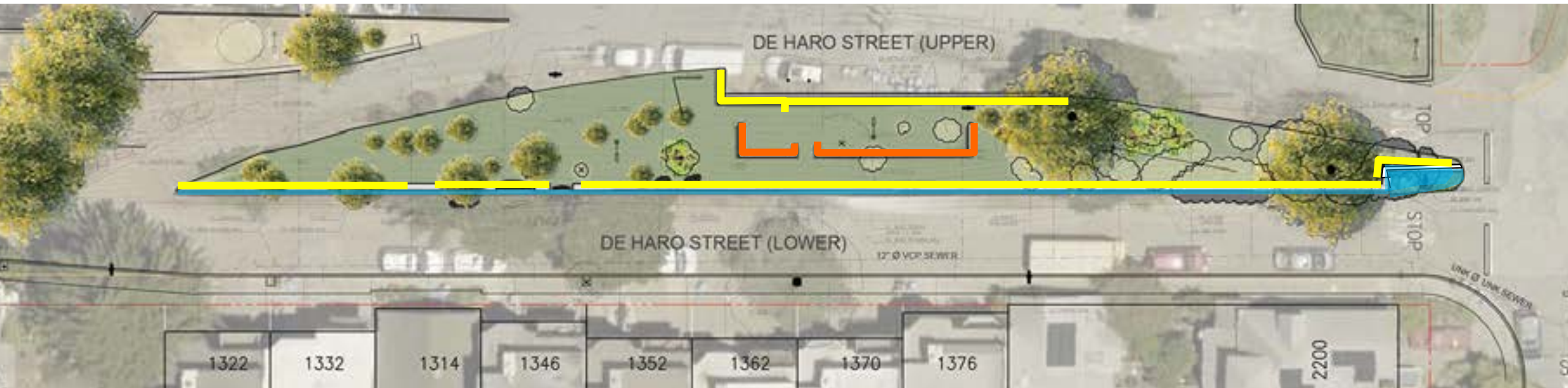

- 2.5' - 3.5' Gabion Retaining Wall
- 3.5' - 4.5' Gabion Retaining Wall

# Project Phasing Budget



Demolition and Site Preparation.....	\$10,121
Earthwork.....	\$6,420
Watershed Improvements.....	\$65,630
Signage.....	\$1,000
Planting and Irrigation .....	\$15,374
Permits Fees and Contingency .....	\$11,825
Softcosts.....	\$39,953

Phase 1 Total: \$149,964

## Lower De Haro Rainwater Management and Beautification

Funding Source: CCG Grant, Watershed Stewardship Grant, DPW Urban Watershed Grant, SFPUC Water Meter/Backflow Grants

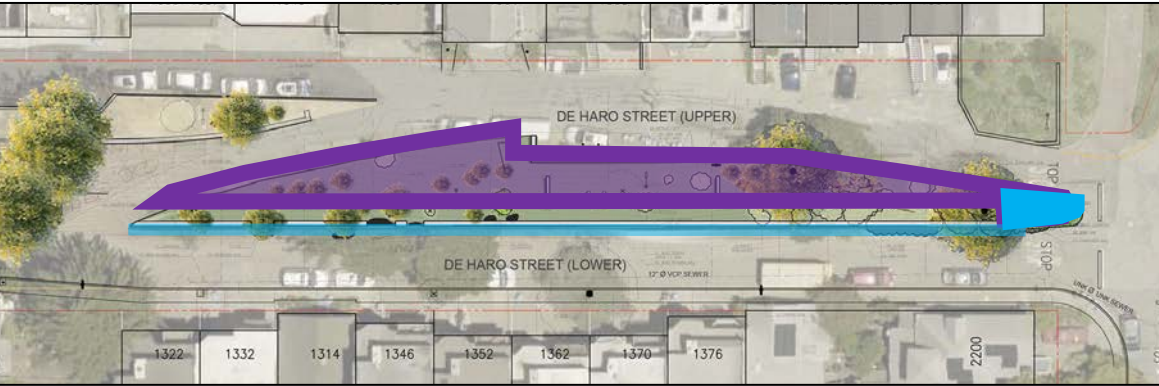

Demolition and Site Preparation.....	\$7,750
Earthwork.....	\$1,625
Hardscape.....	\$52,800
Signage.....	\$1,000
Planting and Irrigation .....	\$32,825
Permits Fees and Contingency .....	\$16,320
Softcosts.....	\$28,080

Phase 2 Total: \$140,400.

## De Haro Terracing & Raingarden Project

Funding Source: CCG Grant

# Conclusion

- We hope you enjoyed and are excited by our project to create a beautiful and walkable greenbelt for all to enjoy. As our neighborhood grows in density, we are committed to enhancing the safety and inspirational hidden gem of our neighborhood over the long term.
- Would you like to get involved? Please visit our [website](https://deharostreetcommunity.org) to:
  - Sign up to join us for our volunteer cleanup days
  - Write a letter of support for our project
  - Support this project by making a donation
  - Watch our progress on our blog
  - <https://deharostreetcommunity.org>
  - [Donate to the De Haro Community Project](#)

DE HARO STREET



Community Project

# Thank you for your time and consideration

## Contact

Email: [deharostreetcommunity@gmail.com](mailto:deharostreetcommunity@gmail.com)

Web: [www.deharostreetcommunity.org](http://www.deharostreetcommunity.org)

We are proud  
to partner with

